

TRINITY HALL // ST. CLEMENTS GARDENS
PUBLIC ART COMMISSION
ARTIST BRIEF

// INTRODUCTION

Trinity Hall is one of the oldest Cambridge colleges with its main site beside the river Cam. St. Clement's Garden, about half a mile away in the City Centre, is a row of 1920's terrace houses that the College has converted to form a hostel for undergraduates. Freeland Rees Roberts are a Cambridge firm of architects, established in 1980, who have designed many buildings for Cambridge and Oxford Colleges. The new building replaces the current terrace with modern and high quality accommodation for undergraduates during the academic year and conference guests in the summer.

As part of Cambridge City Council's ambitious Public Art programme, 1% of the total budget for new developments is allocated to the commissioning of new public art works. Trinity Hall and Freeland Rees Roberts will be submitting the project for planning approval in Autumn 2013 and are looking for the involvement of an artist with a proven track record in delivering innovative and well conceived public art.

This is an exciting opportunity for an experienced artist to produce a significant artwork in the heart of the historical city centre which will engage the Cambridge public, students, and tourists who pass by the building.

We are seeking applications from artists with an interest in the exploration of surface and facade treatments, embedded work, enrichment of the building skin, the use of light, as well as relief based sculpture.

The appointed artist must be prepared to work up an initial proposal and submit a portfolio documenting previous projects for presentation to the planning committee in support of the Autumn planning application.

This brief outlines the details of the project and sets out background information that will inform the artist's approach.

// LOCATION AND THEMES

Bridge Street, which is adjacent to Thompsons Lane, is one of the main roads through the centre of Cambridge. One of the key views of the site will be the view from Bridge St, looking down Thompsons Lane, from where the south corner of the new building is pronounced, and it is important that the work be visible from this point.

- ▶ See Appendix 1: existing and proposed views down Thompsons Lane

The 'tower' element which forms the corner has irregularly placed individual windows and will be clad in a material which will be in harmony with the brick work but separate from it. It is envisaged that a semi-mature Wisteria (or similar) will be planted to climb a trellis on this corner. This deciduous climber could grow up part of the 'tower' element, producing hanging clusters of white, violet or dark indigo petals in spring / summer, and leaving bare wood in winter. Trinity Hall's head gardener will liaise with the artist on the placement of work that will interact with this planting.

- ▶ See Appendix 2 - site elevations

Past this tower is the main entrance to the building, through automatic sliding doors next to a projecting bay window. The entrance is also a possible site for art work.

The benefactor Mr Wyng is from Hong Kong and the College would like to see his name on the building.

- ▶ See appendix 3 - the Wyng Foundation

Materials used on the building façade include brick, stone, zinc, aluminum faced timber window frames, oak structures in the garden with planters and a garden wall in a different brick.

Applicants may wish to explore the following themes:

- ▶ The relationship of hard building materials and plants and the way the plants change seasonally.
- ▶ The location of the building at a transition point between the busy public realm of Cambridge and the more private domestic streets towards Jesus Green.
- ▶ Lighting could be considered as an element of the design, although this must be given careful consideration with respect to the users as well as neighboring residents.

// THE ROLE OF THE ARTIST

The appointed artist will ensure a high quality outcome that enhances the project and which continues the precedent set by both the architects and the college.

Applicants will submit an initial proposal for the commission as well as documentation of previous work in support of their application.

Phase 1 of the project will be the preparation of the application to the Planning Panel. During this phase the appointed artist will develop their initial proposal in liaison with Freeland Rees Roberts and Trinity Hall. The developed proposal will be submitted as part of the planning application, along with a portfolio of the artist's previous public art works.

Over the full course of the project appointed artist will:

- ▶ Produce a full design proposal in accordance with the brief and in line with subsequent planning deadlines
- ▶ Present designs in person as necessary
- ▶ Research the historical background and heritage of the site and use this to inform the work
- ▶ Attend site visits as necessary
- ▶ Work closely with Trinity Hall's architects, Freeland Rees Roberts
- ▶ Provide a fully detailed budget for the work
- ▶ Provide full technical specifications for the fabrication and installation of the work, to include description of any subcontractors that will be used
- ▶ Procure fabrication and installation of the works
- ▶ Undertake to fully assess ongoing maintenance requirements of the work
- ▶ Produce descriptive text explaining the concepts behind and features of the work
- ▶ Attend open day / press at the end of the project if necessary

// BUDGET AND FEES

The total budget for the project is £73,000 inclusive of all fees, design expenses, subcontracted services, fabrication and installation costs, and expenses incurred.

An artist fee of £1000 (including expenses) is allocated to Phase 1 (preparation of the proposal and supplementary information as part of the application to the Planning Panel)

Subject to planning approval, the following sums are indicative of proposed budget allocations for the full project:

Artist fee: £16,000

Fabrication: £36,000

Installation: £17,000

Artist travel and accommodation expenses: £3,000

The artist must deliver the project within the allocated budget.

// FULL TIMELINE

Deadline for application submissions: 26th August 2013 by 5pm

Applicants invited for interview: 12th September 2013

Interviews: 23rd September 2013

Appointment: week following the interview

Deadline for submission of Phase 1 proposal and portfolio of previous work for inclusion in the planning application: October 2013 (to be confirmed)

Subject to planning approvals, the timeline for Phase 2 of the public art delivery plan will be approximately as follows:

Finalised proposal for the public art submitted: Winter 2013

Production period: Summer 2014

Installation period: Winter 2015

// APPLICATIONS

Applicants should submit the following by email to the public art consultant, CJ Mahony:

- ▶ An initial proposal of up to 750 words outlining your approach to the commission and describing your proposed work. Please include details of intended materials and processes as well as explaining your response to any of the themes mentioned in the brief. You may submit up to 3 drawings or indicative images to help the selectors visualize your proposed design.
- ▶ CV
- ▶ Artist bio / profile of up to 300 words
- ▶ Up to 10 images of previous works relevant to the commission
- ▶ Contact information for 2 references

These must be submitted as a single PDF file of not more than 5MB in size. Please clearly caption all images within the document.

Collaborative pairings are welcome to apply. If you are applying as a collaboration, please outline individual roles in your bio / profile.

Submissions must be sent by email to: trinityhall@cjmahony.com

Deadline for submissions: 5pm 26th August 2013.

// INTERVIEWS

The interview day will take on 23rd September 2013 at Trinity Hall in Cambridge. Applicants must be available for interview on this date.

At the interview artists will be expected to present a selection of previous projects relevant to the brief and discuss the initial proposal outlined in their application with the selection panel.

Travel expenses will be reimbursed for interviews at basic rates.

// ADDITIONAL INFORMATION

// HEALTH AND SAFETY

The proposed work must comply with all relevant Health and Safety Regulations

// TECHNICAL REQUIREMENTS AND PROFESSIONAL PRACTICE

Where on-site manufacture or installation will be carried out by the artist and/or subcontractors appointed by the artist, the artist must provide adequate and appropriate public liability insurance.

// MATERIAL AND STRUCTURAL INTEGRITY

The work must be robustly made and have an expected life span of 60 years. Maintenance of the work will be covered by the college but appointed artist will be expected to use materials that are hard wearing and appropriate to maintenance and upkeep. The artist must provide a long term maintenance plan for the work, and should consider the requirement to keep maintenance costs incurred as low as possible.

// TRINITY HALL

www.trinhall.cam.ac.uk

// FREELAND REES ROBERTS

www.frrarchitects.co.uk

Overleaf:

APPENDIX 1: Views from Bridge St - existing and proposed

APPENDIX 2: Site elevations



Side elevation: Thompson's Lane



Entrance

<< 'Tower' element

Bridge Street this way >>

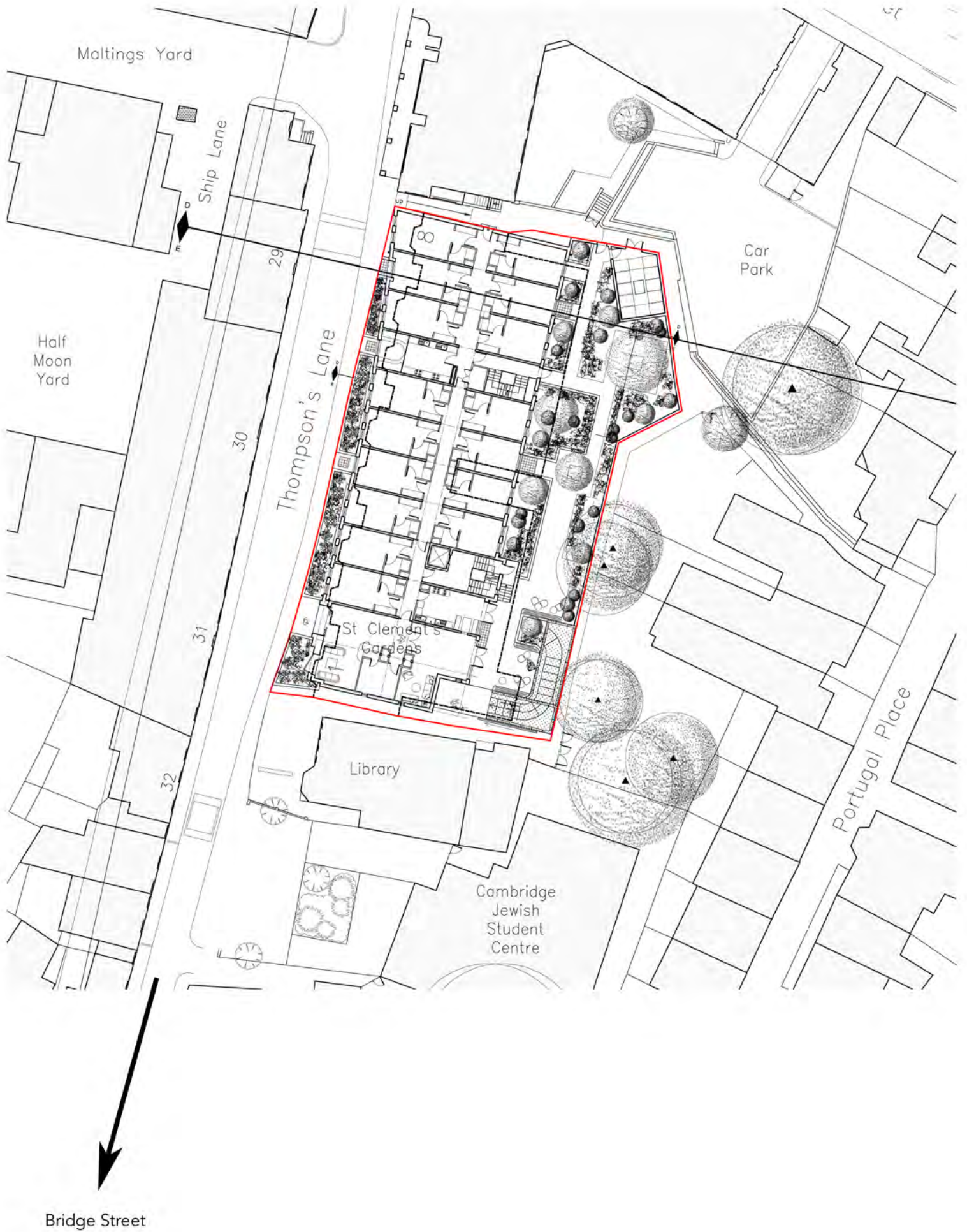

APPENDIX 3:

WYNG Foundation Ltd is a private foundation formed in 2011 in Hong Kong. Its mission is to empower individuals and institutions through education, research and advocacy. The Foundation created the WYNG Trust (Trinity Hall) to provide funding for named Fellowships at Trinity Hall and to establish an academic exchange programme between Cambridge and Hong Kong, and a Schools Outreach programme. The WYNG Foundation has pledged US\$5 million towards the redevelopment of St Clement's Gardens. The new building will accommodate those participating in the academic exchange programme developed by the Foundation with Trinity Hall.

The Foundation's work focuses on education, arts and culture, health, economic, social, environmental and cultural heritage issues. It supports environmental projects, such as the Clean Air Network (CAN) which raises awareness of environmental issues in Hong Kong including air pollution. It also runs an annual photography competition ArtMaster where submissions are based around a single-worded theme, such as Poverty or Air.